

AAN 00871656 (PID 30006639)
183 Eel Lake Dr., Saulnierville Station
LAND DWELLING assessed to Tina Louise Comeau
Total (Taxes, interest, and expenses): **\$1,290.82**

SCHEDULE "A"

2009-06-30 10:46:36

PDCA: NOTIFICATION OF APPROVAL

This is to confirm that we have approved a Parcel Description Certification Application for the following parcel:
30006639

The Type of Application is EXISTING PARCEL.

The Application Number is 339620.

The User Supplied Reference is M1946 H&J (LEBLANC)

Parcel Description:

ALL that certain lot, piece or parcel of land situate, lying and being at Lower Concession, in the County of Digby and Province of Nova Scotia, being more particularly bounded and described as follows:

On the NORTHWEST by a certain line located ten (10') feet Southeast of a certain brook;

On the NORTHEAST by land of Ernest Deveau;

On the SOUTHEAST by the Apolite Road, so-called; and

On the SOUTHWEST by land formerly of Camille Deveau, now land of Medard Comeau.

Containing twenty (20) acres, more or less.

TOGETHER WITH a certain prescriptive use right over a certain road commonly known as the Eel Lake Drive as outlined in a Statutory Declaration filed as Document 76436204 on October 8, 2004, leaving Saulnierville Road (formerly known as Amirault Road) and providing access to and from said Saulnierville Road to the within property.

BEING AND INTENDED TO BE the same lands and premises as conveyed to H.&J. Holdings Limited by Deed dated June 20th, 2002, and recorded at the Land Registration Office for Digby County, on June 28th, 2002, as document #1491.

The parcel was created by a subdivision that predates subdivision control or planning legislation or by-laws in the municipality.

DIGBY COUNTY Land Registration Office

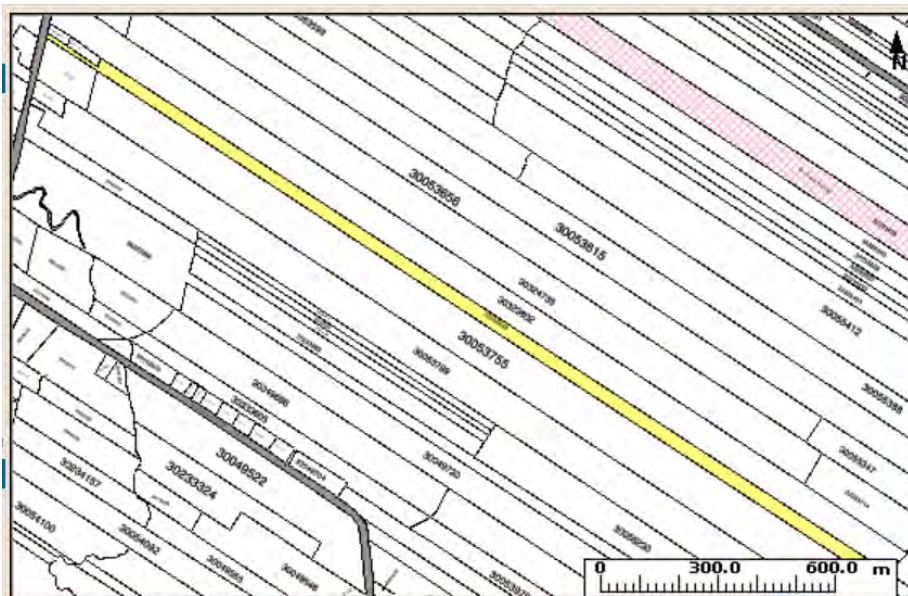

Lat: 44-14-41N Long: 66-03-25W Scale: 14779 Go Zoom: 2

Locatio

1 Property found

PID: 30006639 [Details](#)
AAN: 00871656
Value: \$52,300 (2023 RESIDENTIAL TAXABLE)
\$3,200 (2023 RESOURCE FOREST)
Address: 183 EEL LAKE DRIVE
SAULNIERVILLE STATION
County: DIGBY COUNTY
Owner: TINA LOUISE COMEAU
LR: LAND REGISTRATION